

ACCOMMODATION

Your guide to choosing accommodation at Reading 2017 – 2018

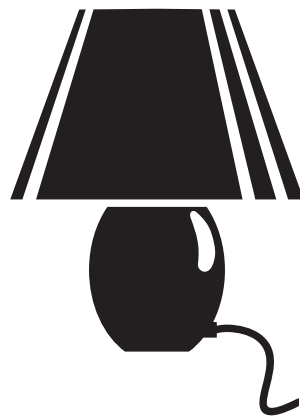
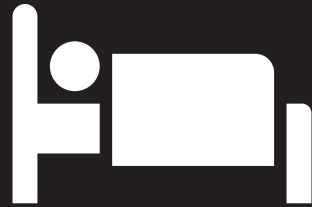

WELCOME

At Reading we offer a wide range of accommodation options. Our halls provide you with a home away from home where you will find yourself part of a supportive community. Each hall has its own distinctive character offering a safe and secure environment in which to study, socialise and relax. This guide provides information to help you select the accommodation that is right for you.

HALLS AT A GLANCE

 **4980**

STUDENT BEDROOMS
ON OR CLOSE TO CAMPUS

 **24/7**

HALLS HOTLINE TO DEAL WITH
ANY HALLS-RELATED ISSUES
QUICKLY AND EFFICIENTLY

 **90%**

OF STUDENTS WOULD RECOMMEND
THEIR HALL TO OTHER STUDENTS*

* UPP Reading Customer Satisfaction Survey, 2015–16

£ 0

UNEXPECTED BILLS TO PAY WITH
OUR ALL-INCLUSIVE RENT †

† Includes utility bills, basic contents insurance
and communal cleaning

ALL HALLS NO MORE THAN

 **15**

MINUTES' WALK FROM THE
LIBRARY ON CENTRAL CAMPUS

 **FREE**
HIGH-SPEED WI-FI

 **7**

EATING OUTLETS TO CHOOSE FROM
AS PART OF THE CATERED PACKAGE

LIVING IN HALLS

GREAT LOCATION

All accommodation is located either on the main Whiteknights campus or within a 15 minute walk.

RANGE OF ACCOMMODATION CHOICES TO SUIT YOUR NEEDS

Choose from catered or self-catered options, a contract length to suit your needs and a variety of different room types to suit your budget and requirements. We also offer accommodation suitable for families, couples and mature students.

ALL INCLUSIVE RENT

including:

- all utility bills
- Wi-Fi
- a basic level of contents insurance
- maintenance
- communal cleaning, including communal kitchen areas



LOW DEPOSIT

A deposit of £250 is all you need to pay to secure your room booking.

SAFE AND SECURE

The halls have regular security patrols each night and CCTV is constantly monitored. Each group of halls has a manned reception.

WELFARE SUPPORT

A dedicated and experienced team of on-site staff wardens take care of/are responsible for all aspects of pastoral care.

'HALLS HOTLINE'

Available 24/7, 365 days of the year ensuring any halls-related issues are dealt with quickly and efficiently.



COMMUNITY

Each hall has its own elected JCR (Junior Common Room) Committee which is made up of students who have previously lived in halls. The JCR Representatives offer peer support and co-ordinate social activities throughout the year, such as Welcome Week events, formal dinners and halls sports teams. All residents can join the JCR and become part of the hall community for a small fee.

'Your Halls Life' is a new initiative that aims to enhance your experience living in halls. There are three different aspects to Your Halls Life, encompassing Life Skills events, Community events and 'We Listen!' events. You will have the opportunity to take part in many different activities. Examples of events we've ran in the past are pool and quiz nights, baking contests, film nights, UK city day trips, Christmas markets and much more throughout the course of the year.



CHOOSING YOUR ACCOMMODATION THINGS TO CONSIDER

STEP 1 APPLYING FOR JUST YOU, OR ARE YOU A COUPLE OR A FAMILY?

Most students need a room just for themselves. However we do provide a variety accommodation options for those applying with a family, in a couple or as a single occupant as a mature student. See our *Families, Couples and Mature Students accommodation guide*: pages 5–12 for full details on the available accommodation.

STEP 2 CATERED OR SELF-CATERED?

Your accommodation choice should be based on how you imagine your lifestyle to be at University. Are you confident in the kitchen and on your way to being the next TV chef? Or are you more of a kitchen nightmare and the idea of cooking for yourself fills you with terror? However you feel, we have both catered and self-catered packages to suit your needs.

Our self-catered package allows you the flexibility of cooking for yourself whenever you like in the comfort of your kitchen ... but don't forget to do the washing up!

STEP 3 YOUR PREFERRED ROOM TYPE

To help you choose your preferred room type, consider whether you are happy to share a bathroom, whether it is important for you to be in a modern hall or would you prefer a more traditional, often larger, style of room? With our large variety of room types, we're confident you'll find your ideal home.

STEP 4 PREFERRED CONTRACT LENGTH?

We have different contract lengths available for full year and shorter periods of study, with entry points in September 2017 and January 2018. Full-time students have the choice of the following contract length*:

- **40 weeks:** You rent your room during term time and the Christmas and Easter vacations, from September to June. This means you move in just before the start of Welcome Week and move out after the end of the Summer Term before the Summer vacation starts. We find this is the most popular option for undergraduates.
- **51 weeks:** You rent your room during term time and the Christmas, Easter and Summer vacations, from September to September. This means you move in just before the start of Welcome Week and move out at the end of the Summer vacation. Postgraduate students often select this option but it also suitable for any undergraduates who would like to use their room over the summer vacation. You are advised to check with your academic department in respect of course dates as to which contract length will be appropriate for you.
- **38 weeks:** There are a limited number of these contracts available at Benyon Hall for the 2017/18 academic year. You rent your room from just before the start of Welcome Week and move out after exams and teaching has finished. This means you can save money but may not have accommodation for the end of summer term activities such as the RUSU ball.

*Not all contract lengths are available in each hall; please see the summary table on **page 14** for a complete overview of our accommodation offering.

YOUR ACCOMMODATION BUDGET



We know as a student, your budget is a big concern. That's why utility bills, Wi-Fi and a basic level of contents insurance are

all included in all our accommodation costs. A catered option may suit you best if you're worried about how you'll budget, as you receive a weekly catering allowance of £65.03 during term time to spend on meals.

Other living costs you might want to consider include laundry charges, the cost of food if you are in a self-catered hall, JCR membership, TV licence, any

additional contents insurance, any travel you may need to do and the money you'll spend socialising.

We suggest that you review your loan entitlement and other planned income to help you work out what you can afford to spend on accommodation. Before you complete your application a summary table can be found on **page 14** for a complete overview of our accommodation offering.

For advice about managing your money and budgeting see www.reading.ac.uk/ready-to-study/study/fees-and-funding.aspx and www.rusu.co.uk/advice/money_advice/



APPLYING FOR ACCOMMODATION

ACCOMMODATION GUARANTEE

You will be guaranteed a place in hall if you are:

- a **new full-time undergraduate** who holds Reading as a firm UCAS choice **and** applies for accommodation by midnight on 1 August **and** satisfies the conditions of your academic offer by 31 August of your year of entry *
- a **new full-time postgraduate** who has accepted an offer from the University **and** applies for accommodation by midnight on 1 August **and** satisfies any conditions of your academic offer by 31 August of your year of entry*.

* Subject to restrictions, please see the Accommodation Policy for more details www.reading.ac.uk/web/FILES/accommodation/Accommodation_Policy_2016-17.pdf

INSURANCE CHOICE

If you choose the University of Reading as your insurance choice you are not guaranteed a place in halls accommodation. You will not be able to apply for accommodation until Reading becomes your firm choice; this is usually the Monday after A Level results. As our halls are usually oversubscribed, it is highly likely you will also need to look at alternative accommodation options.

HOW TO MAKE AN APPLICATION

All applications are made online through the accommodation pages of the personal applicant portal. You will be sent an email when you are eligible to make your application. There is no charge for making an application. At the time of accepting an accommodation offer you will be asked to pay a holding deposit of £250.

SPECIFIC REQUIREMENTS

When making your application, you have the opportunity to note any specific requirements. This includes single gender accommodation, whether you would like to live in a 'quieter lifestyle' area and any medical conditions such as needing a wheelchair accessible room, or other conditions which may affect your time in halls. Please ensure you complete this part of the application accurately to ensure we match your requirements as closely as possible.

Single gender accommodation means sharing a house/flat (not a room) with other students of the same gender. Please be aware in either male or female single gender accommodation there may be guests staying who are of a different gender. There may also be staff members visiting (cleaners, maintenance repairs etc.) who are of a different gender.

We aim to allocate students together who consider themselves to have a 'quieter lifestyle'. Please note, we can't guarantee a permanent quiet environment. Communal living will always involve some level of noise. However by placing students requesting a quieter lifestyle together we hope to better meet the different expectations of our students.

To see which halls which have quieter lifestyle areas and single gender areas please see pages six and seven.

For more information see: www.reading.ac.uk/ready-to-study/accommodation/university-accommodation/specific-requirements.aspx

ACCOMMODATION APPLICATION TIMELINE 2017-2018

9 January, 12 noon to 13 January 2017 12 noon

Returning students: Applications open for current students who will be continuing their studies in 2017-18

21 February 2017, 12 noon

Unconditional offer holders: Applications open for new undergraduates who hold Reading as a Firm UCAS choice and hold an unconditional academic offer

Applications open for new postgraduates who have accepted an unconditional academic offer

Conditional offer holders: Applications open for new undergraduates who hold Reading as a Firm UCAS choice and have a conditional academic offer

Applications open for new postgraduates who have accepted a conditional academic offer

1 August 2017

Guarantee: The deadline to apply for accommodation under the guarantee is midnight on this date. You must then fulfil the terms of your academic offer by 31 August in order to receive a guaranteed place in halls.

From 17 August 2017

Offers made following examination results: Once your academic offer becomes unconditional, usually after examination results, we will do our best to make you an offer of accommodation

21 August 2017, 12 noon

The portal re-opens on this date for insurance students and those coming to Reading through clearing and adjustment, also for anyone else who may be submitting a late application.

For students not under the guarantee (most of this group) the application will be for a place on our waiting list, we recommend you simultaneously start looking at alternate accommodation options.



CATERED ACCOMMODATION

Your stress-free pre-paid approach to eating during term time whilst living in halls.

HOW DOES THE CATERED PACKAGE WORK?

Our catered package offers the best value for money with catered rooms having the lowest room costs (before the catering is applied - see graph). Your rent includes £65.03 per week loaded onto your campus card during term time to use at our catering outlets.

EXAMPLE

CATERED

Catered washbasin room in Windsor Hall, total cost **£148.57** per week for **40 weeks**

Room £101.50 per week for 40 weeks

Catering £65.03 per week for 31 weeks

SELF-CATERED







Premium washbasin room in Wessex Hall, total cost **£115.50** per week for **40 weeks**

Room £115.50 per week for 40 weeks

Self-catering if similar budget for 31 weeks

- **Easy budgeting** £65.03 catering credit is loaded onto your Campus Card every Saturday during term time. You will also receive a 10% discount on selected products to help your money go further.
- **Flexibility and freedom** Spend your allowance as and when you please at seven selected outlets across campus (open early morning to late evening). All catered halls offer small kitchenettes which include at least a fridge, kettle, toaster and microwave.
- **Variety and choice** Each outlet offers a variety of meal options including vegetarian, vegan, Halal, Kosher and gluten-free options.
For example
 - **Breakfast** Cereals, toast, pastries, fruit, porridge and a range of English hot breakfast items.
 - **Lunch** Soups, sandwiches, Panini's, jacket potatoes and pasta dishes. At some outlets there are also grill bars, wok stations and salad bars.
 - **Dinner** Soups, roast dinners, fish and chips, curries and pasta. Pizza, burgers, salad bars and a choice of desserts and fresh fruits are also available



Room type	Total cost per week†	Dunsden Crescent	St Patrick's Hall	Wantage Hall	Windsor Hall
Catered en-suite room	£180.39	 †			
Catered washbasin room with shared bathroom	£151.90			 †	 †
Catered washbasin room with shared bathroom (St Patrick's Hall)	£147.21		 †		
Catered shared bathroom	£143.15		 †	 †	 †

†40 week residency period. Catering allowance of £65.03 per week is included for use during the 31 weeks of term time and Welcome Week.

* single gender areas available † quieter lifestyle areas available



SELF-CATERED ACCOMMODATION

With over 4085 beds, self-catered accommodation is a popular option here at the University of Reading.

In self-catered flats, kitchens are shared between residents and include a hob and oven, microwave, fridge and freezer,

kettle, toaster, cupboard and storage space for each resident. Self-catered residents can load cash onto their campus cards online and receive discounts in the various catering outlets across campus.

See www.reading.ac.uk/campuscards

Room type	Total cost per week‡	Benyon Hall	Bridges Hall	Childs Hall	Greenow & McCombie	Mackinder Hall	Northcourt Houses	St George's Hall	Sherfield Hall	Stenton Hall	Wessex Hall
Premium en-suite room	£164.64		†	* †		* †				* †	
En-suite room	£143.50	* †			* †			†	*		
Townhouse room – limited supply for 1st year undergraduates	£151.90		†							†	
Premium room with shared bathroom	£134.82		* †								
Double premium washbasin	£143.50										
Premium washbasin with shared bathroom	£115.50										* †
Washbasin	£115.50– £124.95										
Study suite	£143.50										
Studio	£143.50– £199.99										

‡ for 40 (or 51 weeks where available) * single gender areas available † quieter lifestyle areas available



PREMIUM EN-SUITE ROOM

SELF-CATERED

Our premium en-suite rooms offer a high standard of accommodation in modern, well-appointed buildings.

The rooms include a 4ft-wide bed, en-suite shower room and fitted furniture. Normally arranged in eight or ten bedroomed flats each with a shared self-catered kitchen/dining room, the shared kitchens are spacious, well-equipped and feature a large dining table which make it an ideal place to eat and socialise with flatmates.

How much will it cost?

Self-catered premium en-suite room

£164.64 per week for 40 or 51 weeks
(51 weeks available at Bridges Hall and Childs Hall)

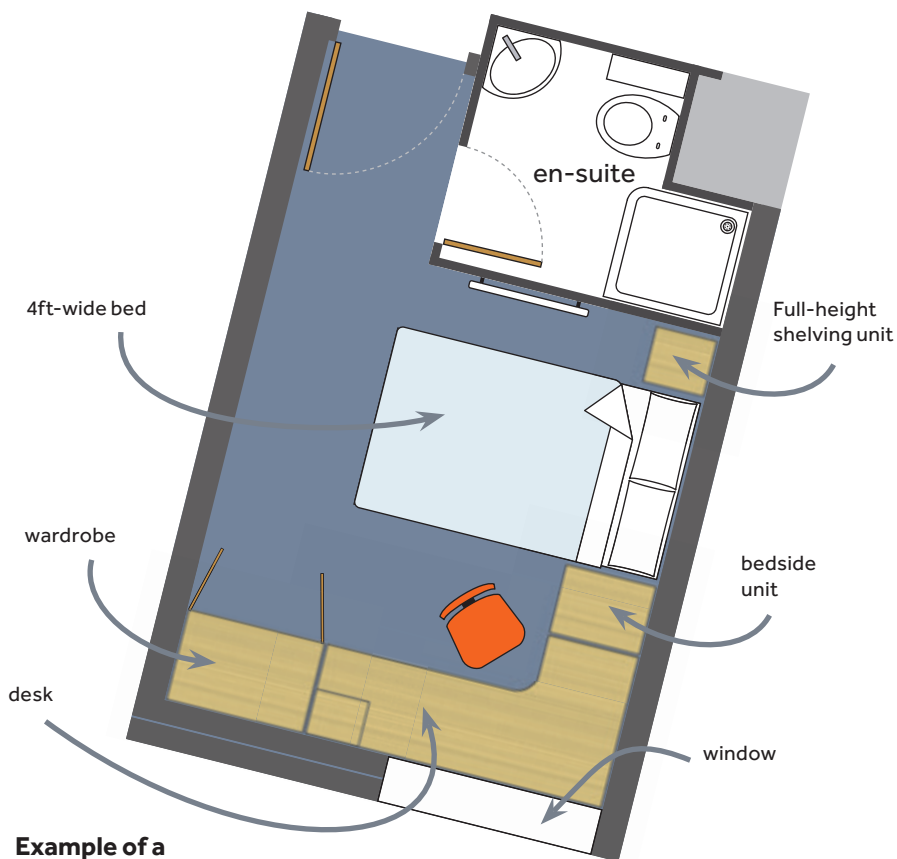

Example of a premium en-suite room

★ 8-10-BEDROOM FLATS PRIVATE BATHROOM

BENYON HALL



Northcourt

16



QL SG



4 mins

BRIDGES HALL



Redlands

63



QL SG



4 mins

CHILDS HALL



Park

594



QL SG



4 mins

MACKINDER HALL



Park

563



QL SG



3 mins

STENTON HALL



Park

402



QL SG



3 mins

EN-SUITE ROOM

En-suite rooms offer a comfortable, well-equipped bedroom with fitted furniture, shelving units and an en-suite shower room, often in a 'wet room' style. There are both catered and self-catered en-suite rooms available.

SELF-CATERED EN-SUITE

Arranged in flats of between six and ten bedrooms, each self-catered flat has a shared kitchen/diner which is well-equipped with appliances and a dining area making them a great communal space for flatmates.

CATERED EN-SUITE

Arranged in flats of between eight and twelve bedrooms, our flats with catered en-suite rooms at Dunsden Crescent have a shared kitchenette for simple meals and drinks. Your catering allowance of £65.03 is loaded onto your campus card every Saturday during term time.

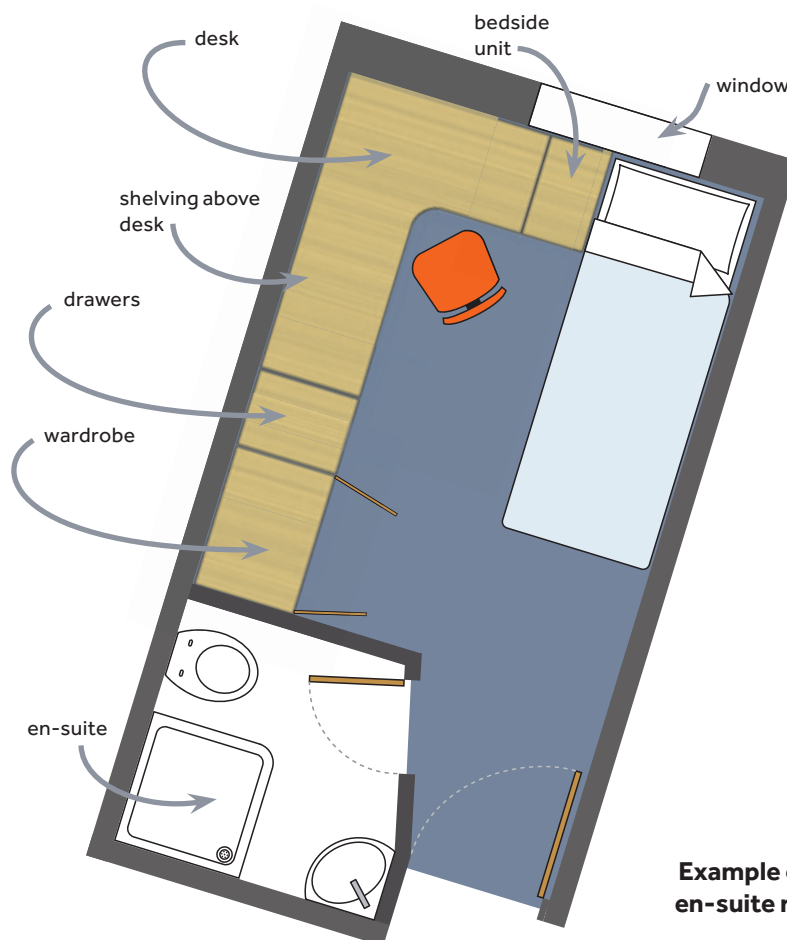

Example of an en-suite room

How much will it cost?

Self-catered en-suite room

£143.50 per week for 40 or 51 weeks

Catered en-suite room

£180.39 per week for 40 weeks, includes £65.03 weekly catering allowance for 31 weeks

★ **6-10 BEDROOM FLATS**
8-12-BEDROOM FLATS
PRIVATE BATHROOM

DUNSDEN CRESCENT



Park

130



4 mins

BENYON HALL



Northcourt

369



4 mins

GREENOW & MCCOMBIE HOUSES



Park

130



4 mins

SHERFIELD HALL



Northcourt

336



4 mins

ST GEORGE'S HALL



Redlands

295



8 mins

PREMIUM SHARED BATHROOM

SELF-CATERED

Our flats with premium shared bathrooms have ten bedrooms which share three bathrooms, a modern kitchen, dining and living area.

The kitchens are light and spacious with a dining table, making them a great place for flatmates to socialise and eat together. The communal facilities include a reception and post room, laundry and covered bicycle stores. Bridges Hall residents have access to Ice House (bar, cafe, mini cinema) which is located in Wessex Hall (adjacent to Bridges). There is also a social space with sofas and TV in the Bridges Reception building.

How much will it cost?

Self-catered premium room with shared bathroom

£134.82 per week for 40 or 51 weeks

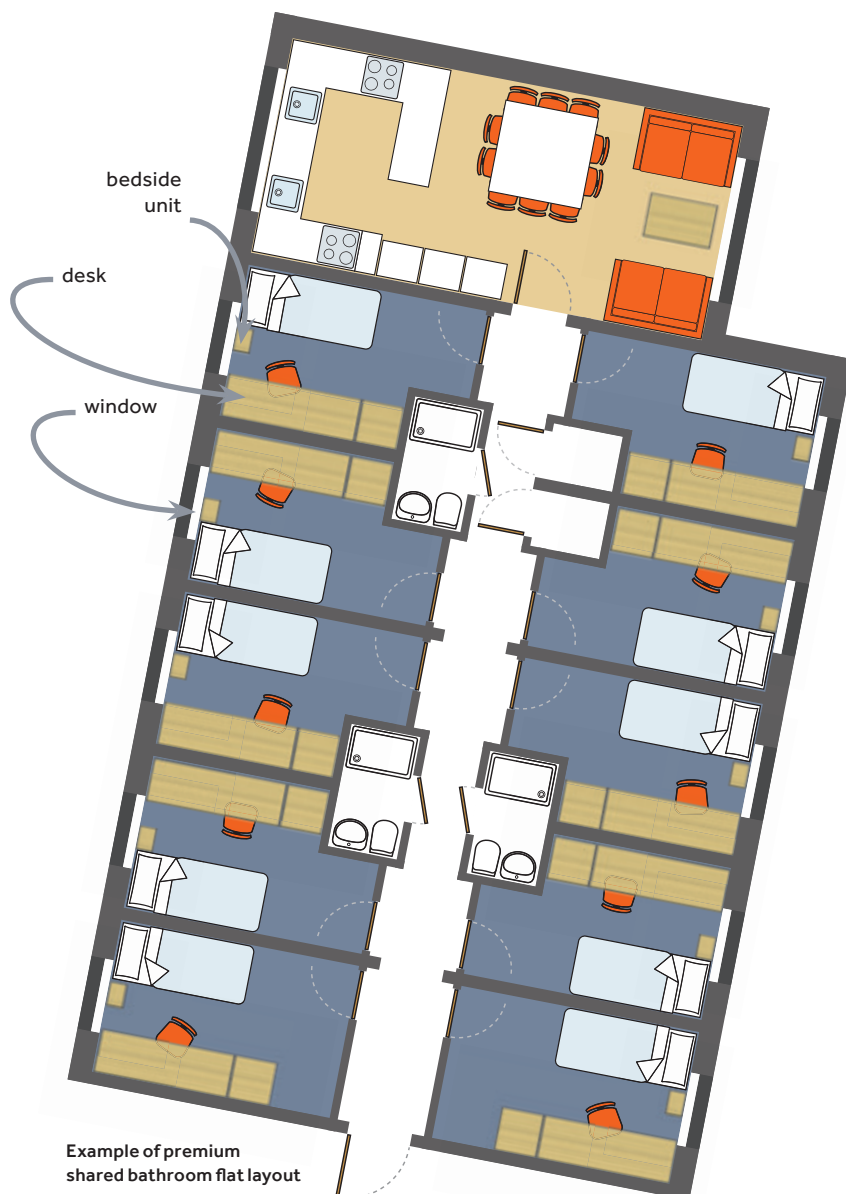

★ 10-BEDROOM FLATS

10 BEDROOMS SHARE THREE BATHROOMS

BRIDGES HALL



Redlands

394



4 mins



TOWNHOUSE ROOM

SELF-CATERED

Our townhouse rooms are arranged in modern, self-catered houses with 12 bedrooms arranged over three floors.

The ground floor of each house includes a large modern kitchen, dining and lounge area for use of all residents. The four bedrooms on each floor share two bathrooms. Stenton Townhouses have 4ft-wide beds and Bridges Townhouses have longer than standard single beds.

A limited number of townhouse rooms will be available for undergraduates.

How much will it cost?

Self-catered townhouse room

Townhouse room with shared bathroom
£151.90 per week for 40 or 51 weeks

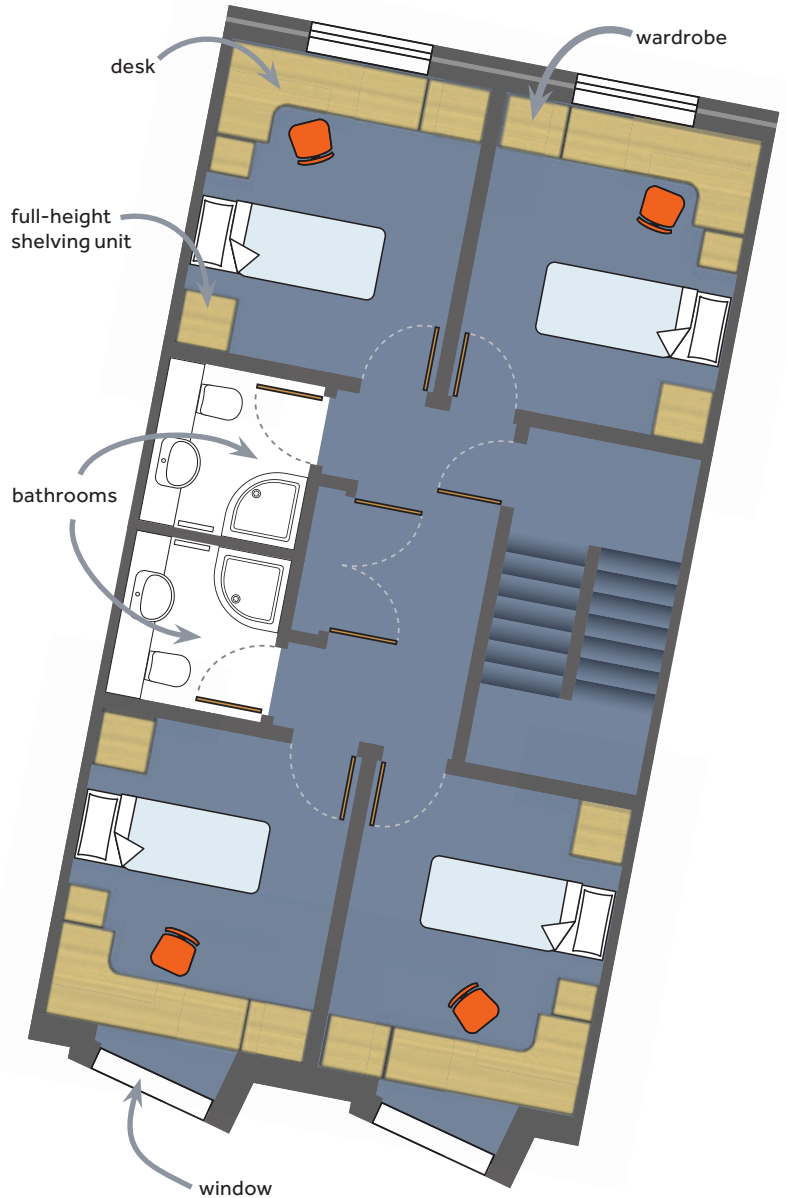

Townhouse first and second floor layout

★ 12-BEDROOM HOUSES

TWO BEDROOMS SHARE ONE BATHROOM

BRIDGES TOWNHOUSES



Redlands

 16

 192



 4 mins

STENTON TOWNHOUSES



Park

 25

 300



4 mins

ROOM WITH SHARED BATHROOM

There are a range of halls offering shared bathroom facilities; many include a washbasin within the room.

PREMIUM WASHBASIN

The washbasin rooms at St George's and Wessex Halls offer kitchen/dining facilities that are shared with other residents in a traditional corridor style arrangement.

CATERED WASHBASIN AND SHARED BATHROOM

Some of our halls include a flexible catering package which allows students to eat at the catering facility at the hall or at other selected catering outlets. The catering package is provided during term time and residents cater for themselves during the Christmas and Easter vacation. Shared kitchenettes are available for preparing simple meals and drinks.

7-11 BEDROOMS SHARING ONE BATHROOM

★ ST GEORGE'S HAS FIVE BEDROOMS SHARING ONE BATHROOM

How much will it cost?

Self-catered room with shared bathroom

Washbasin room (St George's Hall) **£115.50** per week for 40 or 51 weeks
Upgraded room (Wessex Hall) **£143.50** per week for 40 or 51 weeks

Catered room with shared bathroom

Washbasin room **£151.90** per week for 40 weeks (Wantage and Windsor) **£147.21** per week for 40 weeks (St Patrick's) includes £65.03 weekly catering allowance for 31 weeks
Non-washbasin room **£143.15-£157.78** per week for 40 weeks includes £65.03 weekly catering allowance for 31 weeks

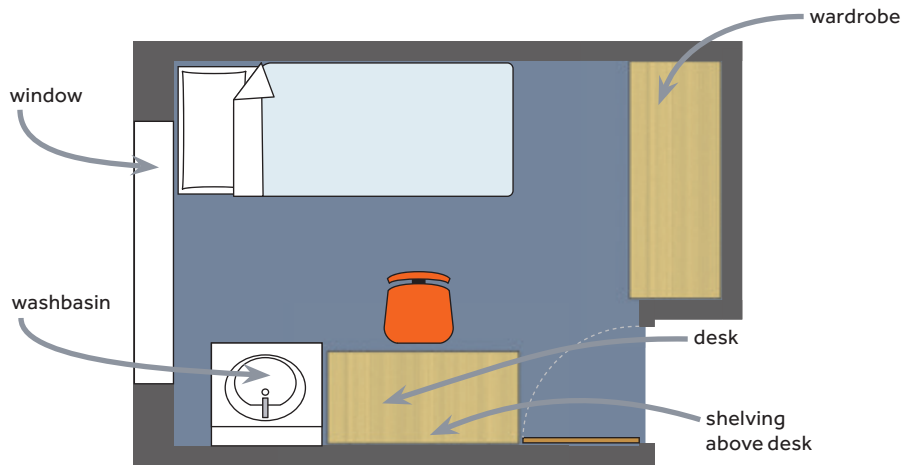

Example of a washbasin room

ST GEORGE'S HALL

Redlands
 107
 self-catered
 QL
 social amenities
 8 mins

ST PATRICK'S HALL

Northcourt
 296
 catered
 QL
 social amenities
 4 mins

WANTAGE HALL

Redlands
 227
 self-catered
 QL
 social amenities

WESSEX HALL

Redlands
 201
 self-catered
 QL
 social amenities

WINDSOR HALL

Park
 233
 catered
 QL SG
 social amenities

SELF-CONTAINED ROOMS

STUDIO

Self-contained studios are available across 16 Northcourt Avenue, St. George's and Wessex Halls. This option is best suited to students who prefer their own private bathroom and kitchen.

Please note: Studio rooms are for single occupancy with the exception of double studios which can accommodate up to two adults.

STUDY SUITE

A study suite includes a bedroom with a double bed and is connected to a private study room. The bathroom and kitchen facilities are shared with other students in a large detached house. There is a limited number of study suites offered at 14 Northcourt Avenue, which are suitable for up to two adults.

All of the halls are conveniently located around campus, with less than 15 minutes' walk to the heart of campus. Our halls are in a great location for local transport to the town centre and Station, local shops and restaurants.

Each individual hall has access to a Group Reception where staff are available to assist with enquiries. The facilities at each hall include a laundry, bike sheds/stands and post boxes.

How much will it cost?

Studio room

£143.50 per week for 51 weeks (Northcourt House)

£199.90 per week for 50 or 51 weeks (St George's)

£265.02 per week for **Study suite** at Northcourt House

£143.50 per week for 51 weeks

ST GEORGE'S HALL



Redlands



14 NORTHCOURT



Northcourt



WESSEX HALL



Redlands



SUMMARY PAGE

Room type	Benyon Hall	Bridges Hall	Childs Hall	Creighton	Dunsden Crescent	Greenow & McCombie	Mackinder Hall	Northcourt Houses	Sherfield Hall	St George's Hall	St Patrick's Hall	Stenton Hall	Wantage Hall	Wessex Hall	Windsor Hall
CATERED					✓						✓		✓		✓
SELF-CATERED	✓	✓	✓	✓		✓	✓	✓	✓	✓	✓	✓	✓	✓	✓
EN-SUITE ROOMS															
Premium en-suite room	✓	✓	✓				✓					✓			
En-suite room	✓				✓	✓			✓	✓					
BATHROOMS															
Premium shared bathroom		✓										✓			
Shared bathroom								✓	✓		✓		✓		✓
Double shared bathroom											✓				
WASHBASIN ROOMS															
Double premium washbasin										✓					
Premium washbasin										✓			✓	✓	
Double washbasin								✓							
Washbasin								✓			✓		✓		✓
ROOMS, STUDIOS AND FLATS															
Townhouse room		✓										✓			
Study suite								✓							
Studio								✓		✓				✓	
Double studio								✓							
One-bed flat				✓				✓	✓	✓			✓		
Two-bed flat				✓							✓				
Quieter lifestyle	✓	✓	✓			✓	✓			✓	✓	✓	✓	✓	✓
Single gender	✓	✓	✓				✓		✓	✓		✓			✓
Bar	✓	✓	✓		✓	✓	✓	✓	✓	✓	✓	✓	✓	✓	✓
Social amenities	✓	✓	✓		✓	✓	✓	✓	✓	✓	✓	✓	✓	✓	✓
Wheelchair accessible rooms		✓	✓				✓					✓			



ACCOMMODATION FOR FAMILIES, COUPLES AND MATURE STUDENTS

We offer a range of accommodation which is suitable for mature single students, couples and families. The accommodation consists of houses with converted rooms and self-contained flats as well as purpose-built studio rooms which are located within the halls.

Just like the standard halls accommodation, the family accommodation has many benefits:

- all-inclusive rent
- great location
- furnished

- safe and secure
- 'Halls hotline'
- Communal cleaning (please note the cleaning of kitchens within studios and self-contained flats is the responsibility of the resident)

For more information see the Accommodation for couples, families and mature students guide on www.reading.ac.uk/ready-to-study/accommodation/university-accommodation.aspx or contact the Accommodation Office to discuss your specific requirements.



FREQUENTLY ASKED QUESTIONS

WHAT'S INCLUDED IN EACH ROOM/FLAT?

All bedrooms are furnished with: bed, mattress and mattress protector, desk, desk chair, shelves and wardrobe. All kitchens are equipped with microwave, fridge, kettle, toaster and ironing board. The kitchens in the self-catered areas also include cookers and freezers. In addition to your personal items, you will need to bring*:

- cookware (such as pots and pans). The premium en-suite rooms at Park Group and the Stenton townhouses have induction hobs so please bring suitable pans
- crockery and utensils
- towels, bed linen, duvet and pillows
(the premium en-suite and Stenton townhouse rooms require linen to fit 4ft-wide beds)
(rooms in Bridges Hall require a sheet to fit a double bed as they are a non-standard size and longer than a standard single bed)

*a more detailed list of what you do and don't need to bring with you to your accommodation is included in your arrival guide, see below.

WHAT INFORMATION WILL I RECEIVE BEFORE I ARRIVE?

Once you have accepted a place in hall you will be asked to complete an online induction. This will include a link to your hall Arrivals Guide which will provide valuable arrivals information, details of what to bring and an insight into hall life to prepare you for your time in hall.

CAN I LIVE IN HALL ACCOMMODATION BEYOND THE FIRST YEAR?

There is limited accommodation in halls for returning students. Residents are contacted in the first term with details of how and when to apply for accommodation for the following year.

ACCOMMODATION GUIDE

 For more information, please contact:

Accommodation Office

Carrington Building
University of Reading
Whiteknights
Reading RG6 6UA
United Kingdom

accommodationonline@reading.ac.uk

Tel +44 (0)118 378 4203

www.reading.ac.uk/accommodation

CAN I GET AN ACCESSIBLE ROOM?

The University's Disability Team provides support and advice and works closely with the Accommodation Team to assist students with special requirements. Contact disability@reading.ac.uk or **0118 378 8921** as soon as possible if you need an accessible room or have particular requirements of your room due to a disability.

CAN I BRING MY CAR OR BICYCLE WITH ME?

Except in very specific cases students living in halls are unable to bring a car and the area around the University is for residents parking only. For all information regarding car, motorcycle or visitor parking please see www.reading.ac.uk/parking

All halls are within easy walking distance of Whiteknights campus and conveniently close to excellent bus routes serving supermarkets, Reading town centre and train station.

Cycling is encouraged and bike sheds/racks are available in all of the halls.

CAN I ACCESS THE INTERNET FROM MY HALL ROOM?

Wi-Fi is available across the halls. Each bedroom also includes a fixed wire connection to the University's readingConnect IT system. This is a University IT service delivering broadband access to the University campus data network and the internet.

DO I NEED TO MOVE OUT FOR THE CHRISTMAS AND EASTER VACATIONS?

The residency periods include the Christmas and Easter vacations there is no need to move out of your hall room during these times.

Please note

All photos are examples of facilities on offer and individual rooms may vary. Whilst every effort has been made to ensure that the details outlined in this booklet are correct at the time of publication, some arrangements may be subject to change.



The University of Reading is committed to providing quality student accommodation and fully complies with the Student Accommodation Code. See www.thesac.org.uk for more details. The code covers, among other matters, health and safety, maintenance and repair, and relationships between the University and student tenants. It outlines best practice and provides benchmarks for the management – and quality – of student housing in the sector.